

Verbreiterung 30 mm
incl. Dichtung
Verstärkung: Art.-Nr. 602
Art.-Nr. **360**

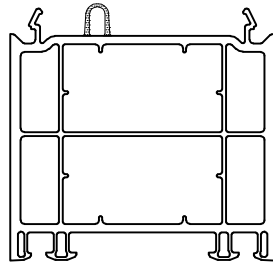

Verbreiterung 60 mm
incl. Dichtung
Verstärkung: Art.-Nr. 604
Art.-Nr. **362**

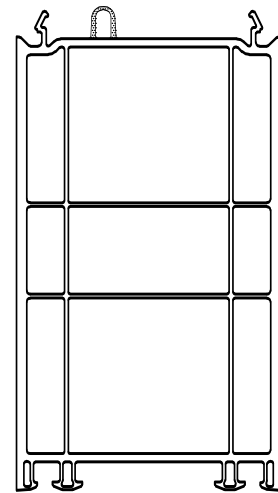

Verbreiterung 120 mm
incl. Dichtung
Verstärkung: Art.-Nr. 655
Art.-Nr. **363**

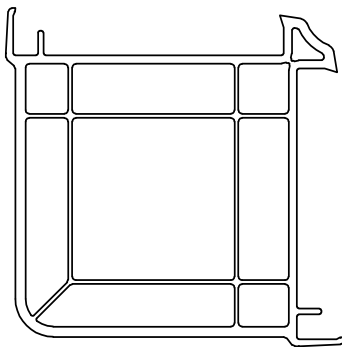

Eckkopplung 90°
Verstärkung: Art.-Nr. 655
Art.-Nr. **355**

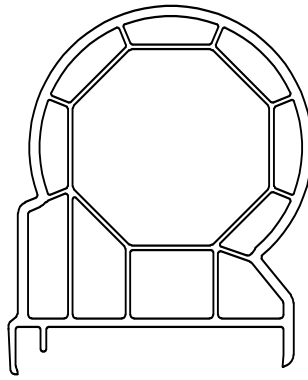

Variable Eckkopplung
Verstärkung: Art.-Nr. 640
Art.-Nr. **340**

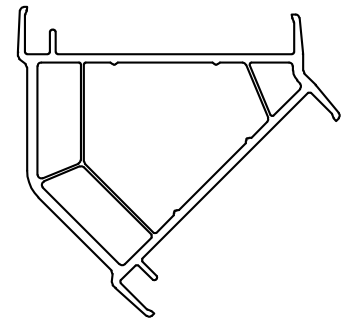

Eckkopplung 135°
Verstärkung: Art.-Nr. 656
Art.-Nr. **6356**

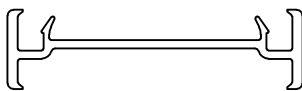

Kopplungsleiste
Art.-Nr. **350**

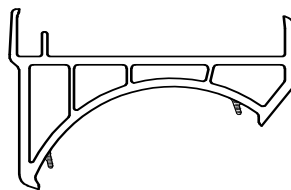

Adapter für variable
Eckkopplung
incl. Dichtung
Art.-Nr. **341**

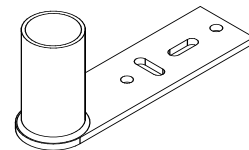

Montageanker
zu Art.-Nr. 640
Art.-Nr. **A 640**

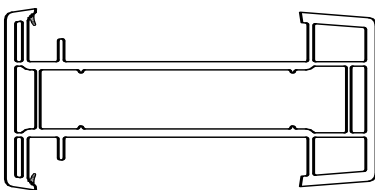

H-Kopplung
incl. Dichtung
Verstärkung: Art.-Nr. 208
Befestigungsanker: Art.-Nr. AR 152,
AL 152, AI 152
Art.-Nr. **352**

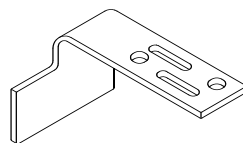

Befestigungsanker
rechts
(zu Art.-Nr. 352)
Art.-Nr. **AR 152**

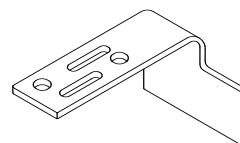

Befestigungsanker
links
(zu Art.-Nr. 352)
Art.-Nr. **AL 152**

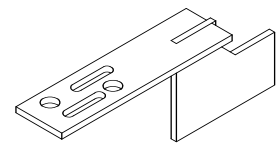

Befestigungsanker
innen
(zu Art.-Nr. 352)
Art.-Nr. **AI 152**

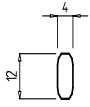

verdeckt liegende
Kopplung
Art.-Nr. **1248**

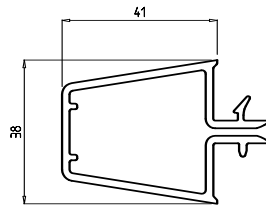

Kopplungsummantelung
Verstärkung: Art.-Nr. 7209
Art.-Nr. **153**

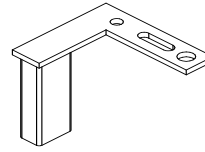

Befestigungsanker
(zu Art.-Nr. 7209)
Art.-Nr. **A 153**

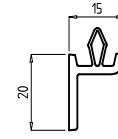

Anschlusswinkel 20 mm
Art.-Nr. **148**

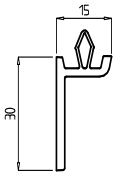

Anschlusswinkel 30 mm
Art.-Nr. **149**

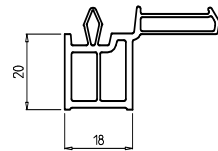

Universalanschluss 20 mm
Art.-Nr. **345**

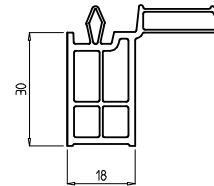

Universalanschluss 30mm
Art.-Nr. **346**

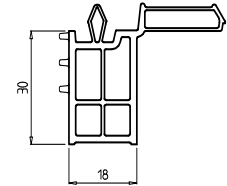

Universalanschluss 30 mm
Art.-Nr. **346F**

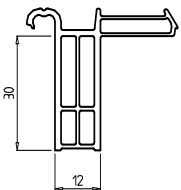

Universalanschluss 30 mm
Art.-Nr. **349**

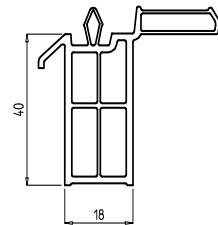

Universalanschluss 40 mm
Art.-Nr. **344**

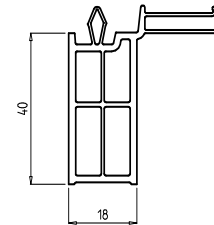

Universalanschluss 40 mm
Art.-Nr. **348**

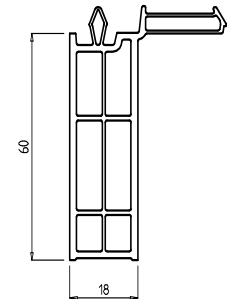

Universalanschluss 60 mm
Art.-Nr. **141**

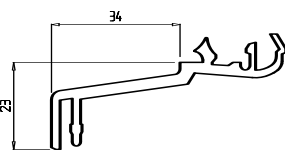

Fensterbankanschluss,
21/34 mm Ausladung
Art.-Nr. **FB 34**

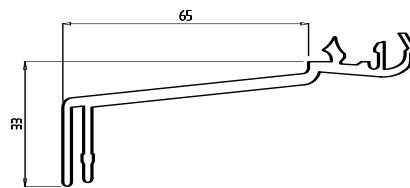

Fensterbankanschluss,
52/65 mm Ausladung
Art.-Nr. **FB 65**

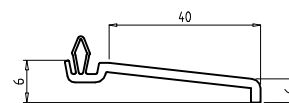

Fensterbankanschluss
für innen
40 mm Ausladung
Art.-Nr. **FB 40**

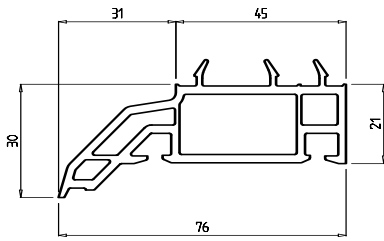

Fensterbank 76 mm
Verstärkung: Art.-Nr. 606
Art.-Nr. **FB 31**

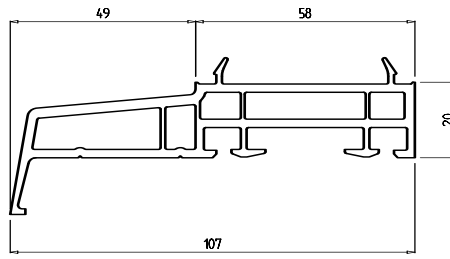

Fensterbank 107 mm
Art.-Nr. **FB 49**

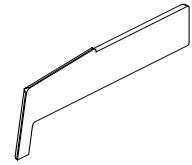

Endkappen
Art.-Nr. **KFB 49**

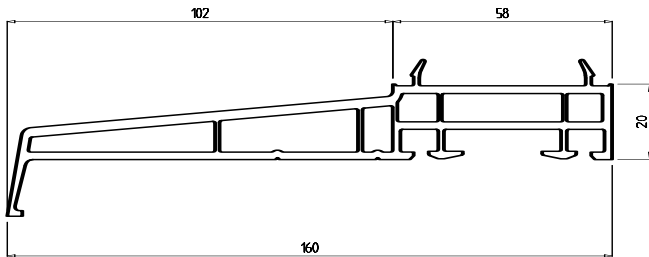

Fensterbank 160 mm
Art.-Nr. **FB 102**

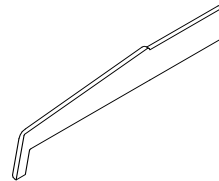

Endkappen
Art.-Nr. **KFB 102**

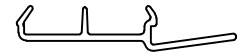

Unterrastung
Art.-Nr. **7747**

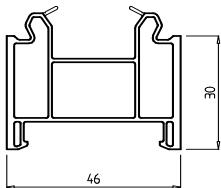

Bankanschluss 30 mm
Art.-Nr. **342**

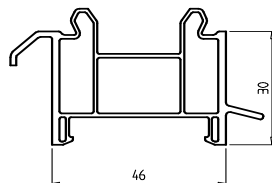

Bankanschluss 30 mm
Art.-Nr. **7343**

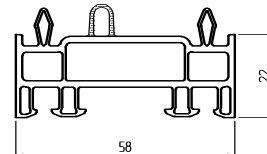

Verbreiterung 22 mm
Art.-Nr. **741**

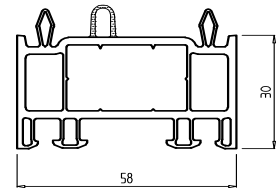

Verbreiterung 30 mm
incl. Dichtung
Verstärkung: Art.-Nr. 606
Art.-Nr. **144**

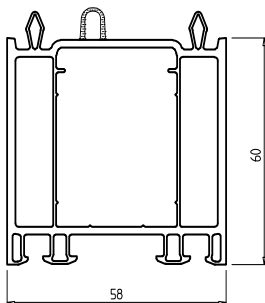

Verbreiterung 60 mm
Verstärkung: Art.-Nr. S 304020, 219
Art.-Nr. **546**

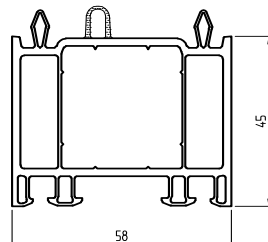

Verbreiterung 45 mm
incl. Dichtung
Verstärkung: Art.-Nr. 634
Art.-Nr. **545**

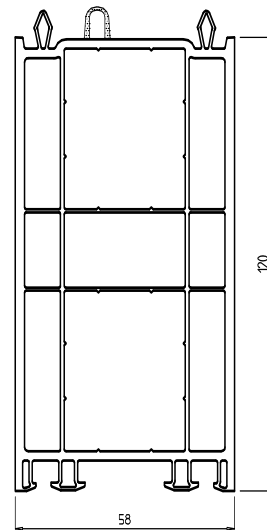

Verbreiterung 120 mm
incl. Dichtung
Verstärkung: Art.-Nr. S 304020, 219
Art.-Nr. **147**

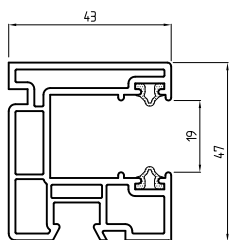

Rolladenführungsschiene
mit Dichtung
Art.-Nr. **1085**

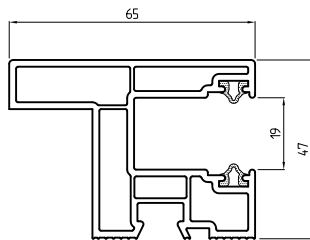

Rolladenführungsschiene
mit Dichtung
Art.-Nr. **5666**

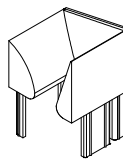

Einlauftrichter
(zu Art.-Nr. 1085, 5666)
Art.-Nr. **T 1085**

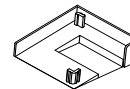

Endkappen
(zu Art.-Nr. 1085, 5666)
Art.-Nr. **K 1085**

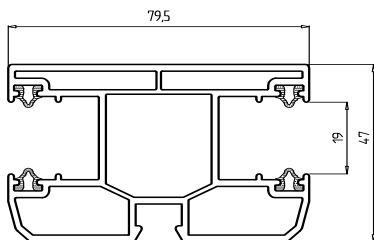

doppelte Rolladen-
führungsschiene
mit Dichtung
Art.-Nr. **4095**

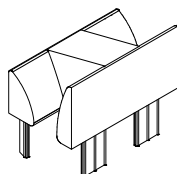

Einlauftrichter
(zu Art.-Nr. 4095)
Art.-Nr. **T 4095**



Klemmschiene
(zu Art.-Nr. 174, 574, 779)
Art.-Nr. **773**



Schraubnippel
(zu Art.-Nr. 1085, 4095, 5666)
Art.-Nr. **1195**



Schraubnippel
(zu Art.-Nr. 174, 574, 779)
Art.-Nr. **194**



Rolladenkasten-
aufnahme 10 mm
Art.-Nr. **163**

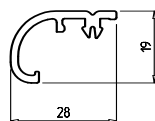

Rolladenablauf
Art.-Nr. **161**

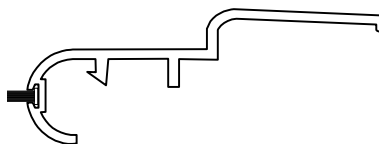

Rolladenkastentraverse
mit Dichtung
für 10 mm Aufnahme
Art.-Nr. **164**



Bürstendichtung
zu Art.-Nr. 164
Art.-Nr. **D 164**



Sprosse
selbstklebend
26 x 9 mm,
mit anextrudierter Dichtung
Art.-Nr. **SP 750**



Sprosse
selbstklebend
27 x 13 mm,
mit anextrudierter Dichtung
Art.-Nr. **SP 2713**



Sprosse
selbstklebend
27 x 8 mm,
mit anextrudierter Dichtung
Art.-Nr. **SP 2708**

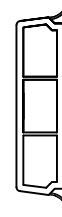

Sprosse
selbstklebend
47 x 13 mm,
mit anextrudierter Dichtung
Art.-Nr. **SP 4713**

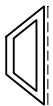

Sprosse
selbstklebend
26 x 10 mm
Art.-Nr. **SP 751**



Sprosse
selbstklebend
47 x 8 mm,
mit anextrudierter Dichtung
Art.-Nr. **SP 4708**



Sprosse
selbstklebend
76 x 13 mm,
mit anextrudierter Dichtung
Art.-Nr. **SP 7613**



Sprosse
selbstklebend
76 x 8 mm,
mit anextrudierter Dichtung
Art.-Nr. **SP 7608**

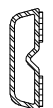

Alu-Sprosse
selbstklebend
27 x 8,7 mm,
Art.-Nr. **SP 92708**

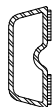

Alu-Sprosse
selbstklebend
27 x 11,2 mm,
Art.-Nr. **SP 92710**

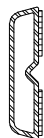

Alu-Sprosse
selbstklebend
35 x 8,7 mm,
Art.-Nr. **SP 93508**



Alu-Sprosse
selbstklebend
35 x 11,2 mm,
Art.-Nr. **SP 93510**

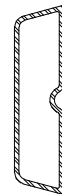

Alu-Sprosse
selbstklebend
50 x 14 mm,
Art.-Nr. **SP 95013**

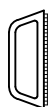

Sprosse
selbstklebend
26 x 10,3 mm,
Art.-Nr. **SP 92609**



Sprosse
selbstklebend
26 x 12 mm,
Art.-Nr. **SP 92611**



Sprosse
selbstklebend
35 x 10,3 mm,
Art.-Nr. **SP 93509**

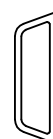

Sprosse
selbstklebend
35 x 12 mm,
Art.-Nr. **SP 93511**

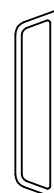

Sprosse
selbstklebend
50 x 12 mm,
Art.-Nr. **SP 95011**



Stulp-Anschlag
innen 30 mm
Art.-Nr. **7791**



Endkappen
(zu Art.-Nr. 7791)
Art.-Nr. **K 7791**



Stulp-Anschlag
innen 60 mm
Art.-Nr. **779**

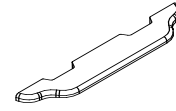

Endkappen
(zu Art.-Nr. 779)
Art.-Nr. **K 779**

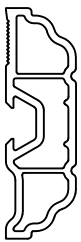

Verblendung
Art.-Nr. **7792**

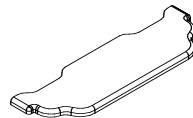

Endkappen
(zu Art.-Nr. 7792)
Art.-Nr. **K 7792**

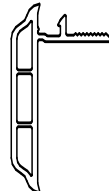

Verblendung
50 x 7,5 mm
Art.-Nr. **7795**

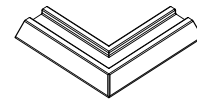

Eckverbinder
(zu Art.-Nr. 7795)
Art.-Nr. **V 7795**

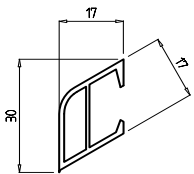

Wetterschenkel
17 x 17 mm
Art.-Nr. **174**

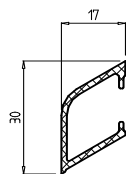

Alu-Wetterschenkel
17 x 17 mm
Art.-Nr. **174**



Endkappen
(zu Art.-Nr. 174)
Art.-Nr. **K 174**

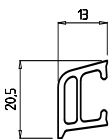

Wetterschenkel
20,5 x 13 mm
Art.-Nr. **574**

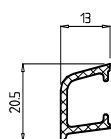

Alu-Wetterschenkel
20,5 x 13 mm
Art.-Nr. **574**



Endkappen
(zu Art.-Nr. 574)
Art.-Nr. **K 574**

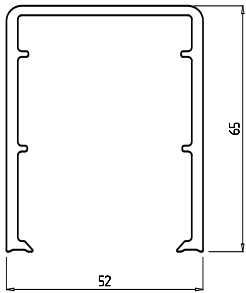

Lisene
Verstärkung: Art.-Nr. 614, S 604025
Art.-Nr. **154**

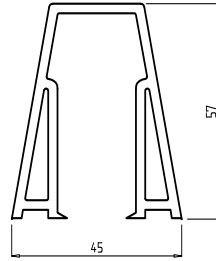

Lisene
Verstärkung: Art.-Nr. 205
Art.-Nr. **1114**

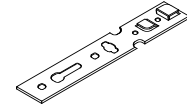

Montageanker
Art.-Nr. **7220**

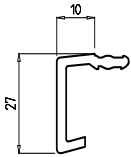

Fensterbankabdeckung
27 x 10 mm
Art.-Nr. **559**



Trittschutz
Art.-Nr. **7182**

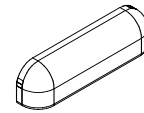

Schlitzkappen
Art.-Nr. **195**

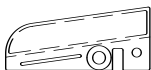

Endkappe
zu Art.-Nr 184
Art.-Nr. **K 184**

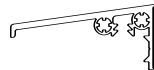

Trittschwelle
Art.-Nr. **184**

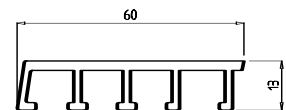

Laibung 60 mm
Art.-Nr. **563**

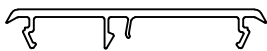

Blendrahmenabdeckung
Art.-Nr. **7562**

Alle Stahlausenmaße haben einen Toleranzbereich von $+0$ mm
 $-0,5$ mm

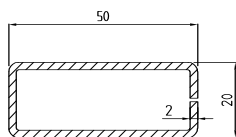

Systembezug
ZU
1114

Verstärkung
Art.-Nr. **205**
 $I_x = 7,3 \text{ cm}^4$
 $I_y = 1,7 \text{ cm}^4$

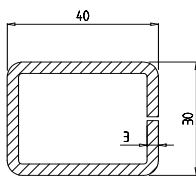

Systembezug
ZU
546

Verstärkung
Art.-Nr. **219**
 $I_x = 7,5 \text{ cm}^4$
 $I_y = 4,8 \text{ cm}^4$

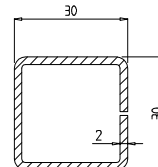

Systembezug
ZU
545

Verstärkung
Art.-Nr. **634**
 $I_x = 2,8 \text{ cm}^4$
 $I_y = 2,8 \text{ cm}^4$

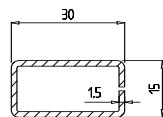

Systembezug
ZU
FB 31
144

Verstärkung
Art.-Nr. **606**
 $I_x = 1,3 \text{ cm}^4$
 $I_y = 0,4 \text{ cm}^4$

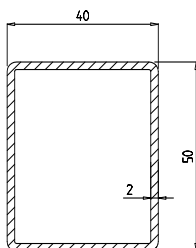

Systembezug
ZU
154

Verstärkung
Art.-Nr. **614**
 $I_x = 8,5 \text{ cm}^4$
 $I_y = 12,0 \text{ cm}^4$

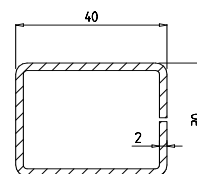

Systembezug
ZU
147

Verstärkung
Art.-Nr. **S 304020**
 $I_x = 5,6 \text{ cm}^4$
 $I_y = 3,6 \text{ cm}^4$

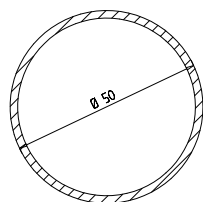

Systembezug
ZU
340

Verstärkung
Art.-Nr. **640**
 $I_x = 8,7 \text{ cm}^4$

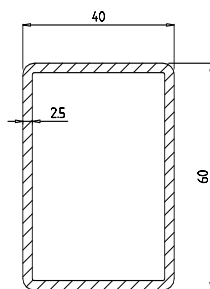

Systembezug
ZU
154

Verstärkung
Art.-Nr. **S 604025**
 $I_x = 12,1 \text{ cm}^4$
 $I_y = 22,8 \text{ cm}^4$

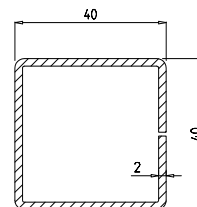

Systembezug
ZU
355
363

Verstärkung
Art.-Nr. **655**
 $I_x = 7,0 \text{ cm}^4$
 $I_y = 7,1 \text{ cm}^4$

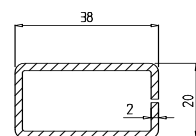

Systembezug
ZU
362

Verstärkung
Art.-Nr. **604**
 $I_x = 3,6 \text{ cm}^4$
 $I_y = 1,3 \text{ cm}^4$

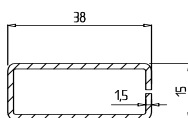

Systembezug
ZU
360

Verstärkung
Art.-Nr. **602**
 $I_x = 2,4 \text{ cm}^4$
 $I_y = 0,5 \text{ cm}^4$

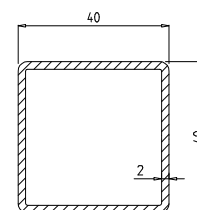

Systembezug
ZU
355
363

Verstärkung
Art.-Nr. **645**
 $I_x = 7,1 \text{ cm}^4$
 $I_y = 7,1 \text{ cm}^4$

Alle Stahlaußenmaße haben einen Toleranzbereich von $+0$ / $-0,5$ mm

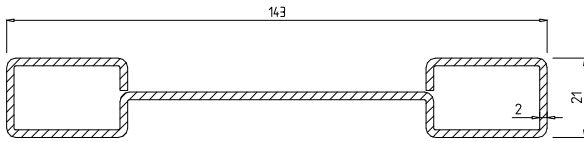

Systembezug
ZU
153

Verstärkung
Art.-Nr. **7209**
 $I_x = 130 \text{ cm}^4$
 $I_y = 2,55 \text{ cm}^4$

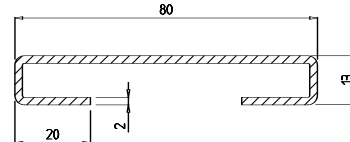

Systembezug
ZU
352

Verstärkung
Art.-Nr. **208**
 $I_x = 20,2 \text{ cm}^4$
 $I_y = 0,7 \text{ cm}^4$

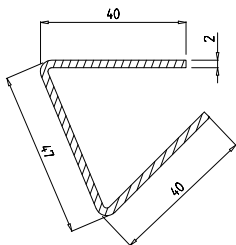

Systembezug
ZU
6356

Verstärkung
Art.-Nr. **656**
 $I_x = 3,5 \text{ cm}^4$
 $I_y = 4,4 \text{ cm}^4$