

Blendrahmen 63 mm
Art.-Nr. **390.07**

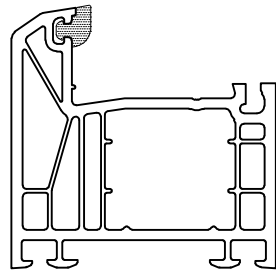

Blendrahmen 69 mm
Art.-Nr. **370.07**

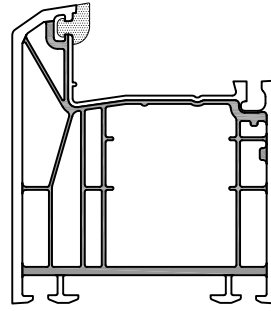

Blendrahmen 79 mm
Art.-Nr. **3372.07**

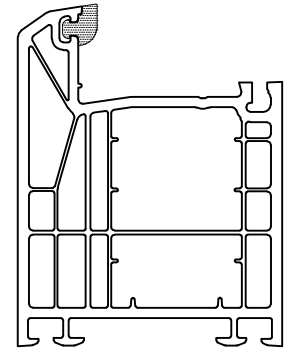

Blendrahmen 90 mm
Art.-Nr. **371.07**



Blendrahmen mit werkseitig
eingebrachter äußerer 4 mm
Anschlagdichtung
Art.-Nr. **xxx.07**

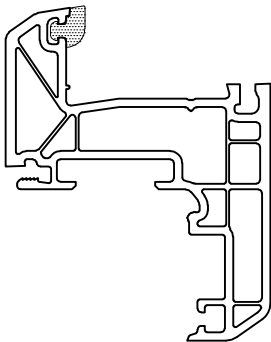

Umbaublendrahmen 88 mm
Art.-Nr. **331.07**

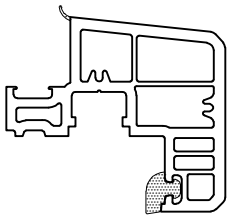

Flügel flächenversetzt 52 mm
GlassWin_System
Art.-Nr. 2399

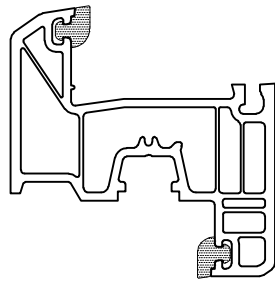

Flügel 71 mm
Art.-Nr. 397.67

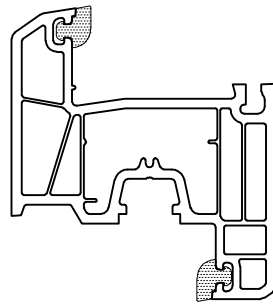

Flügel 77 mm
Art.-Nr. 395.67

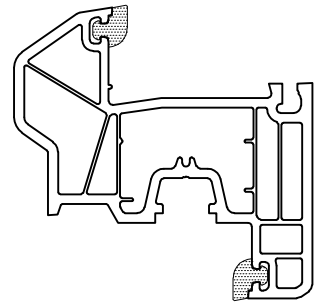

Stilflügel 77 mm
Art.-Nr. 396.67

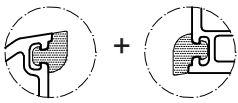

Flügel mit werkseitig eingebrachter äußerer
4 mm Verglasungsdichtung in Verbindung
mit werkseitig eingebrachter innerer 4 mm
Anschlagdichtung
Art.-Nr. xxx.67

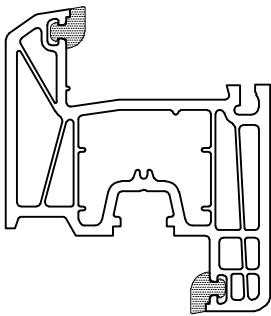

Flügel 80 mm
Art.-Nr. 375.67

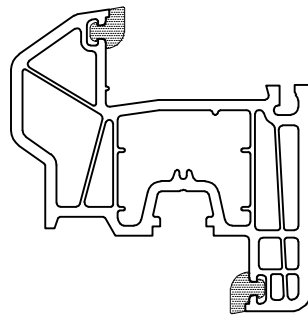

Stilflügel 80 mm
Art.-Nr. 376.67

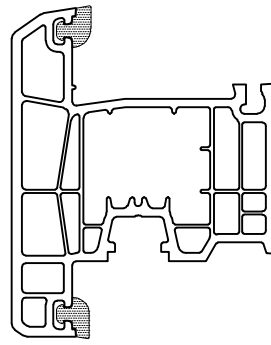

T-Flügel
außen öffnend 87 mm
Art.-Nr. 319.67

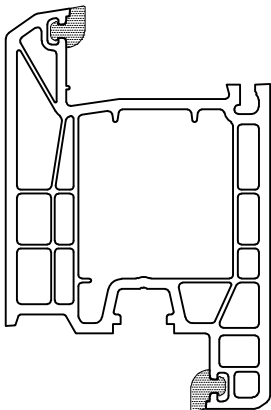

Tür-Flügel
innen öffnend 106 mm
Art.-Nr. 373.67

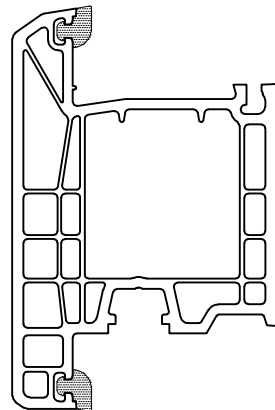

Tür-Flügel
außen öffnend 106 mm
Art.-Nr. 374.67

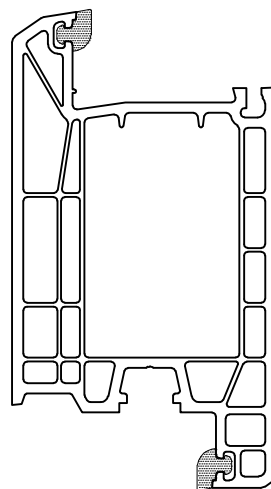

Tür-Flügel
innen öffnend 126 mm
Art.-Nr. 378.67

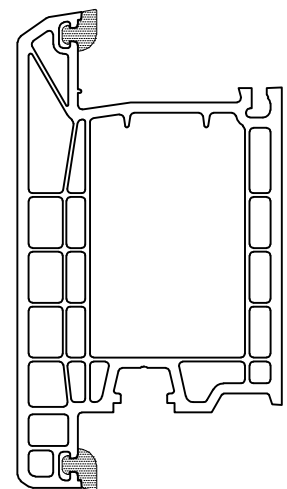

Tür-Flügel
außen öffnend 126 mm
Art.-Nr. 379.67



Pfosten mit beidseitig
eingebrachter 4 mm
Anschlagdichtung
Art.-Nr. **xxx.77**

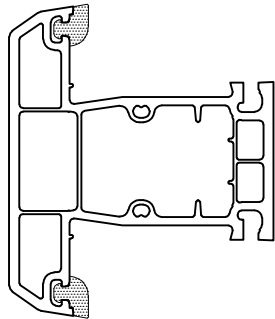

Pfosten/
Flügelspanne 82 mm
Art.-Nr. **392.77**

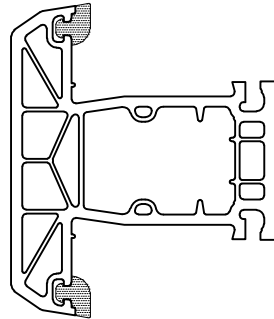

Pfosten/
Flügelspanne 82 mm
Art.-Nr. **380.77**

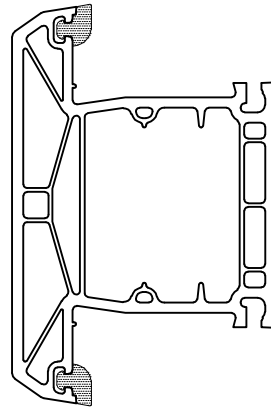

Pfosten/
Flügelspanne 105 mm
Art.-Nr. **382.77**

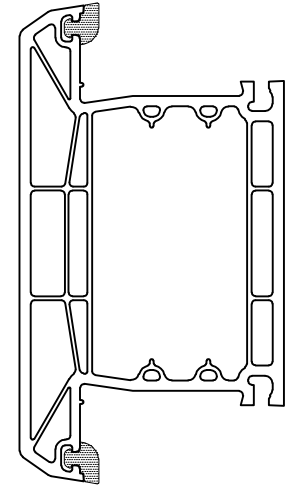

Pfosten/
Flügelspanne 126 mm
Art.-Nr. **381.77**



Stulp mit eingebrachter
4 mm Anschlagdichtung
Art.-Nr. **xxx.06**

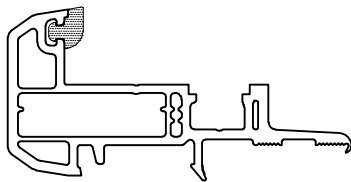

Stulp 44 mm
Art.-Nr. **386.06**

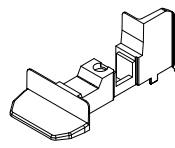

Stulpabdeckung
zu Art.-Nr. 386
Art.-Nr. **K 386**

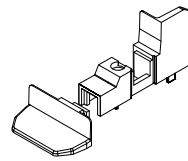

Stulpabdeckung 2-teilig
zu Art.-Nr. 386
Art.-Nr. **K 3862**

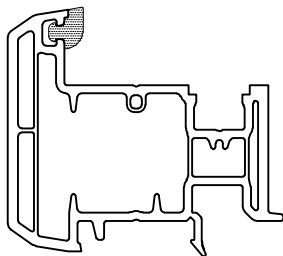

Stulp 64 mm
Art.-Nr. **385.06**

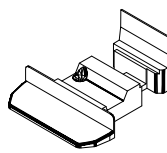

Stulpabdeckung
zu Art.-Nr. 385
Art.-Nr. **K 385**

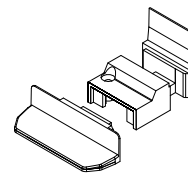

Stulpabdeckung 2-teilig
zu Art.-Nr. 385
Art.-Nr. **K 3852**

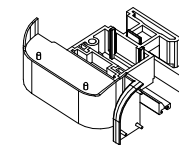

Stulpabdeckung unten
(in Verbindung
mit dem Schwellensystem)
zu Art.-Nr. 385
Art.-Nr. **K 3851L**
Art.-Nr. **K 3851R**



Pfosten mit beidseitig eingebrachter
4 mm Anschlagdichtung
Art.-Nr. **xxx.77**

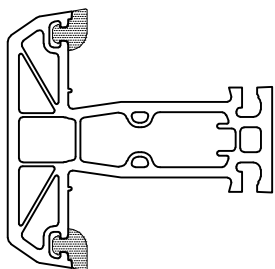

Flügelspanne 68 mm
Art.-Nr. **SP 368.77**

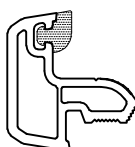

Stulp 36 mm
mit Dichtung
Art.-Nr. **387.06**



Stulpabdeckung
zu Art.-Nr. 387
Art.-Nr. **K 387**

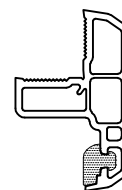

Stulp 48 mm
mit Dichtung
Art.-Nr. **7796.06**

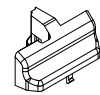

Stulpabdeckung
zu Art.-Nr. 7796
Art.-Nr. **K 7796**

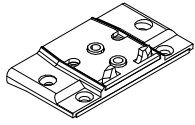

Pfosten /
Flügelspinnenverbinder
zu Art.-Nr. 380, 392
Art.-Nr. **V 380**

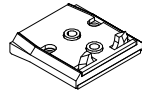

Pfosten /
Flügelspinnenverbinder
zu Art.-Nr. 380, 392
Art.-Nr. **V 380A**

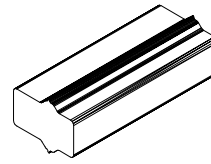

Pfostenverbinder
für Schrägelemente
zu Art.-Nr. 380, 392
Art.-Nr. **V 380S**

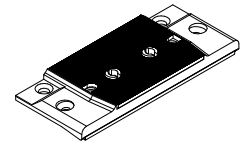

Pfosten /
Flügelspinnenverbinder
zu Art.-Nr. 382
Art.-Nr. **V 382**

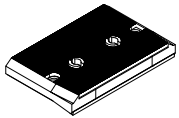

Pfosten /
Flügelspinnenverbinder
zu Art.-Nr. 382
Art.-Nr. **V 382A**

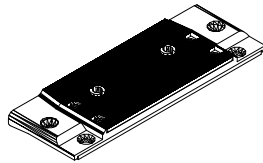

Pfosten /
Flügelspinnenverbinder
zu Art.-Nr. 381
Art.-Nr. **V 381**



Pfosten /
Flügelspinnenverbinder
zu Art.-Nr. 381
Art.-Nr. **V 381A**

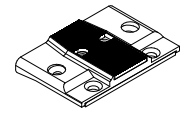

Flügelspinnenverbinder
zu Art.-Nr. SP 368
Art.-Nr. **VSP 368**

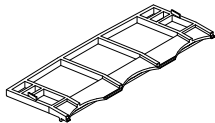

Klotzbrücke
Art.-Nr. **KB 70**



Klotzbrücke
zu Art.-Nr. 2399
Art.-Nr. **KB SG1**

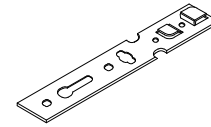

Montageanker
für Blendrahmen
Art.-Nr. **7220**

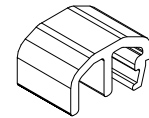

Auflaufbock
für Blendrahmen und Kämpfer
Art.-Nr. **199**

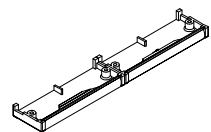

REGEL-air®
Art.-Nr. **RA 17AD**



REGEL-air®
Überschlagslüfter in
Kombination mit
Art.-Nr. RA17AD einsetzbar im
Flügelüberschlag
Art.-Nr. **RA17UL**



Nutabdeckung
für Glasleistenaufnahme
Art.-Nr. **179**



Handeinzug-/
Reparaturdichtung
verschweißbar
Art.-Nr. **DP 6**



Handeinzug-/
Reparaturdichtung
B, 4 mm verschweißbar
Art.-Nr. **DP 7**

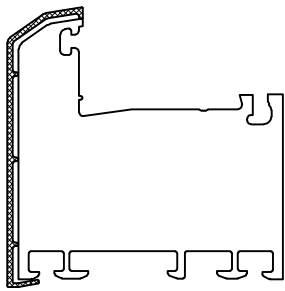

Aluschale
zu Art.-Nr. 370
Art.-Nr. **AS 370**

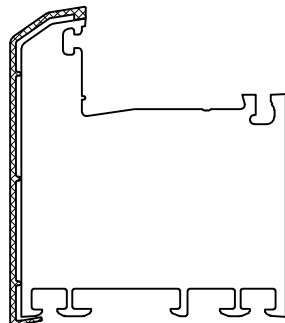

Aluschale
zu Art.-Nr. 372
Art.-Nr. **AS 372**

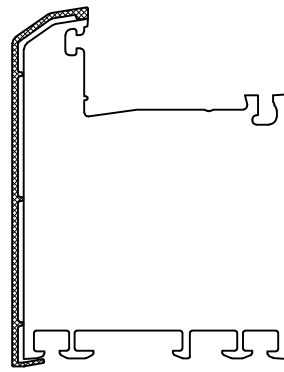

Aluschale
zu Art.-Nr. 371
Art.-Nr. **AS 371**

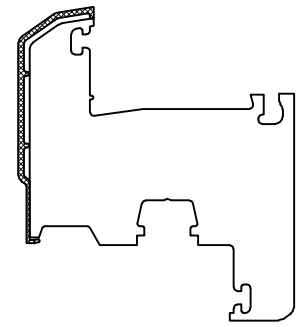

Aluschale
zu Art.-Nr. 375
Art.-Nr. **AS 375**

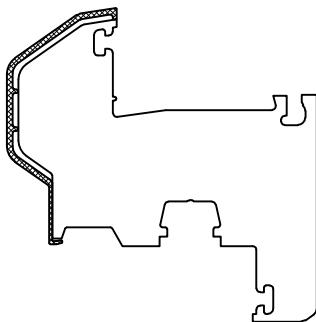

Aluschale
zu Art.-Nr. 376
Art.-Nr. **AS 376**

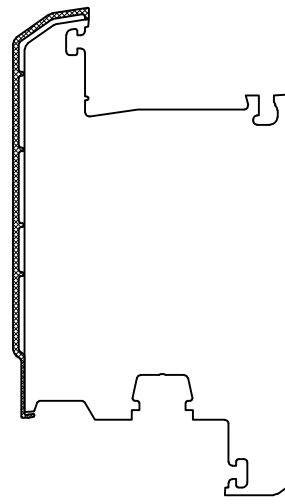

Aluschale
zu Art.-Nr. 378
Art.-Nr. **AS 378**

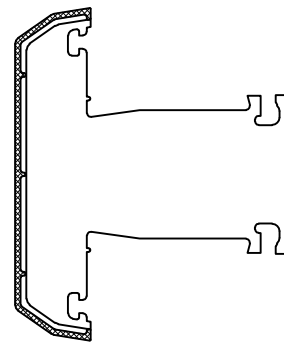

Aluschale
zu Art.-Nr. 380
Art.-Nr. **AS 380**

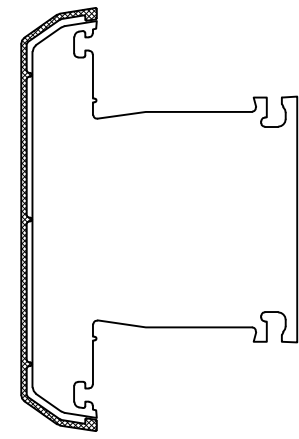

Aluschale
zu Art.-Nr. 382
Art.-Nr. **AS 382**

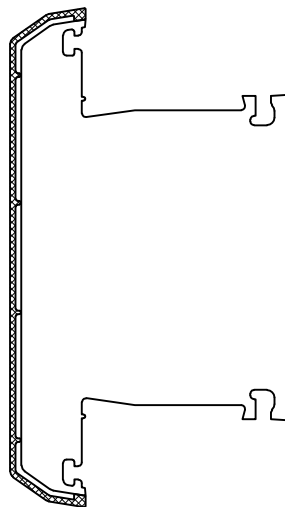

Aluschale
zu Art.-Nr. 381
Art.-Nr. **AS 381**

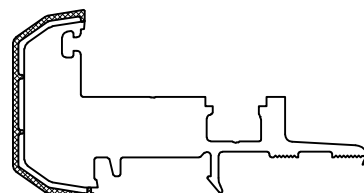

Aluschale
zu Art.-Nr. 386
Art.-Nr. **AS 386**

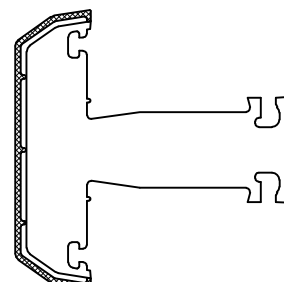

Aluschale
zu Art.-Nr. SP 368
Art.-Nr. **AS 368**

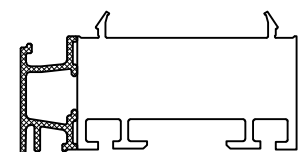

Aluschale
für Verbreiterung 30mm
Art.-Nr. **AS 30**

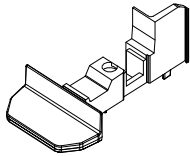

Aluschale Abdeckkappe
zu Art.-Nr. 386
Art.-Nr. **ASK 386**

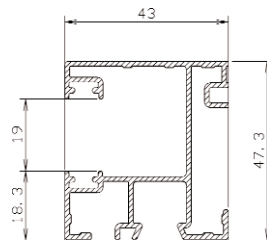

Alu-Rolladenführungsschiene
Art.- Nr. **5760**

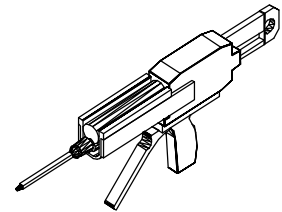

Aluschale Handdruckpistole
Art.- Nr. **ASP 250**

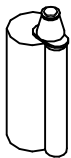

Aluschale Kleber
Kartusche 250ml
Art.-Nr. **ASK 250**

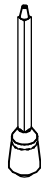

Aluschale Statikmscher
für Kleber 250ml
Art.- Nr. **ASM 250**



Aluschale Vorbehandlungsmittel
(Primer)
Art.- Nr. **ASV 250**



Art.- Nr. **AS D04**
Dichtung 2 mm



Art.- Nr. **AS D03**
Dichtung 4 mm



Glasleiste 20 mm
Art.-Nr. **320.04*/320.02****



Glasleiste 16 mm
Art.-Nr. **016.04***



Stilglasleiste 16 mm
Art.-Nr. **076.04*/076.02****



Glasleiste 16 mm
abgeschrägt
Art.-Nr. **096.04***



Glasleiste 16 mm
Art.-Nr. **326.04***



Glasleiste 14 mm
Art.-Nr. **014.04***



Glasleiste 12 mm
Art.-Nr. **012.04***



Stilglasleiste 12 mm
Art.-Nr. **072.04*/072.02****



Glasleiste 12 mm
Art.-Nr. **322.04***



Glasleiste 10 mm
Art.-Nr. **010.04***



Glasleiste 8 mm
Art.-Nr. **008.04*/ 008.02****



Glasleiste 6 mm
Art.-Nr. **006.02****



Verglasungsdichtung A
umlaufend, 2 mm
Art.-Nr. **254**



Verglasungsdichtung B
umlaufend, 4 mm
Art.-Nr. **255**



Falzverbreiterung 16 mm
für System_70mm (Anschlagdichtung)
Art.-Nr. **728**

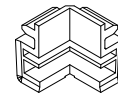

Eckverbinder
zu Art.-Nr. 728
Art.-Nr. **V 728**



Handeinzugsvariante 2 mm
für Glasleisten
Art.-Nr. **DP 4**



Handeinzugsvariante 4 mm
für Glasleisten
Art.-Nr. **DP 5**

* mit eingebrachter 4 mm Dichtung
** mit eingebrachter 2 mm Dichtung

Alle Stahlaußenmaße haben einen Toleranzbereich von $+0$ / $-0,5$ mm

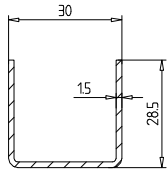

Verstärkung
Art.-Nr. **S 3701**
 $I_x = 1,94 \text{ cm}^4$
 $I_y = 1,1 \text{ cm}^4$

Systembezug

AD
332
370
371
375
376
870
875

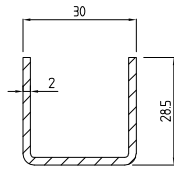

Verstärkung
Art.-Nr. **S 3702**
 $I_x = 2,5 \text{ cm}^4$
 $I_y = 1,4 \text{ cm}^4$

Systembezug

AD
332
370
371
375
376
870
875

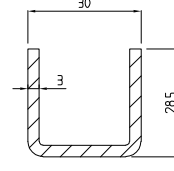

Verstärkung
Art.-Nr. **S 3703**
 $I_x = 3,4 \text{ cm}^4$
 $I_y = 1,9 \text{ cm}^4$

Systembezug

AD
332
370
371
375
376
870
875

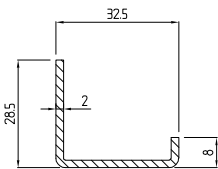

Verstärkung
Art.-Nr. **S 3702A**
 $I_x = 1,7 \text{ cm}^4$
 $I_y = 1,0 \text{ cm}^4$

Systembezug

AD
332
370
371
375
376
870
875

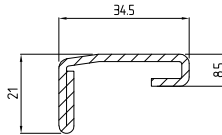

Verstärkung
Art.-Nr. **S 3772**
 $I_x = 2,4 \text{ cm}^4$
 $I_y = 0,6 \text{ cm}^4$

Systembezug

AD
377

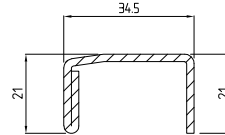

Verstärkung
Art.-Nr. **S 3772A**
 $I_x = 3,1 \text{ cm}^4$
 $I_y = 0,7 \text{ cm}^4$

Systembezug

AD
377

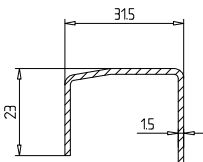

Verstärkung
Art.-Nr. **207**
 $I_x = 1,8 \text{ cm}^4$
 $I_y = 0,6 \text{ cm}^4$

Systembezug

AD
390
395
396

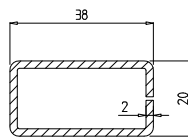

Verstärkung
Art.-Nr. **604**
 $I_x = 3,6 \text{ cm}^4$
 $I_y = 1,3 \text{ cm}^4$

Systembezug

AD
380
385
392

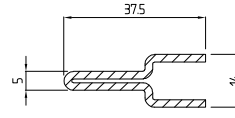

Verstärkung
Art.-Nr. **S 3682**
 $I_x = 1,8 \text{ cm}^4$
 $I_y = 0,3 \text{ cm}^4$

Systembezug

AD
SP 368

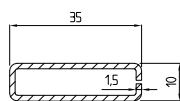

Verstärkung
Art.-Nr. **218**
 $I_x = 1,5 \text{ cm}^4$
 $I_y = 0,2 \text{ cm}^4$

Systembezug

AD
386

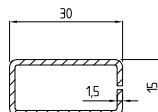

Verstärkung
Art.-Nr. **606**
 $I_x = 1,3 \text{ cm}^4$
 $I_y = 0,4 \text{ cm}^4$

Systembezug

AD
371

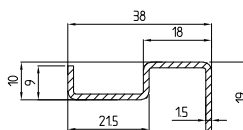

Verstärkung
Art.-Nr. **S 3311**
 $I_x = 1,8 \text{ cm}^4$
 $I_y = 0,2 \text{ cm}^4$

Systembezug

AD
331

Alle Stahlausenmaße haben einen Toleranzbereich von **+ 0**
- 0,5 mm

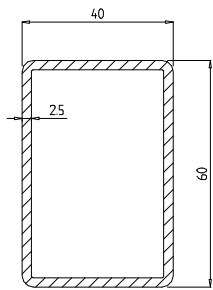

Systembezug
AD
378
379
381

Verstärkung
Art.-Nr. **S 604025**
 $I_x = 12,1 \text{ cm}^4$
 $I_y = 22,8 \text{ cm}^4$

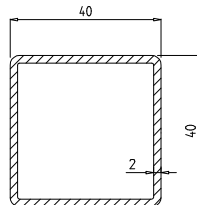

Systembezug
AD
373
374
382
355

Verstärkung
Art.-Nr. **645**
 $I_x = 7,1 \text{ cm}^4$
 $I_y = 7,1 \text{ cm}^4$

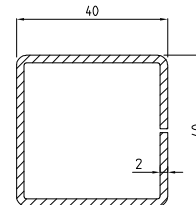

Systembezug
AD
373
374
382
355

Verstärkung
Art.-Nr. **655**
 $I_x = 7,0 \text{ cm}^4$
 $I_y = 7,1 \text{ cm}^4$

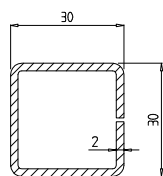

Systembezug
AD
370
371
870

Verstärkung
Art.-Nr. **634**
 $I_x = 2,8 \text{ cm}^4$
 $I_y = 2,8 \text{ cm}^4$

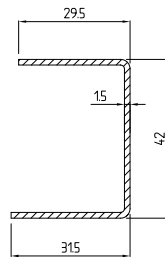

Systembezug
AD
3372

Verstärkung
Art.-Nr. **S 8372**
 $I_x = 1,4 \text{ cm}^4$
 $I_y = 4,4 \text{ cm}^4$

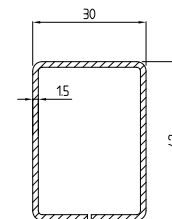

Systembezug
AD
3372

Verstärkung
Art.-Nr. **S 304215**
 $I_x = 3,0 \text{ cm}^4$
 $I_y = 4,9 \text{ cm}^4$

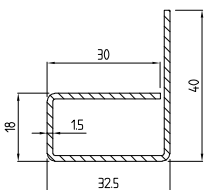

Systembezug
AD
3372

Verstärkung
Art.-Nr. **S 3722**
 $I_x = 2,5 \text{ cm}^4$
 $I_y = 1,9 \text{ cm}^4$